



Manufactured for:  
**Fora Care Inc.**  
 810 Lawrence Drive, Suite 104  
 Newbury Park, CA 91320 USA  
 Toll Free: 1-866-469-2632  
 Hours of Operation: 24 hours, 7 days/Week

315-4244100-006

For self-testing:  
 Read instructions before use.  
 For in-vitro diagnostic use only.

**Dear FORA V10 System Owner:**  
 Thank you for choosing FORA V10 Blood Glucose Monitoring System to take control of your diabetes.

FORA V10 is helpful in tracking your blood glucose values.

Quick Start User Guide assists you in setting up the system and testing your blood glucose. Please read it carefully before use. For complete information on system usage and features, refer to the Owner's Manual.

Items For Testing

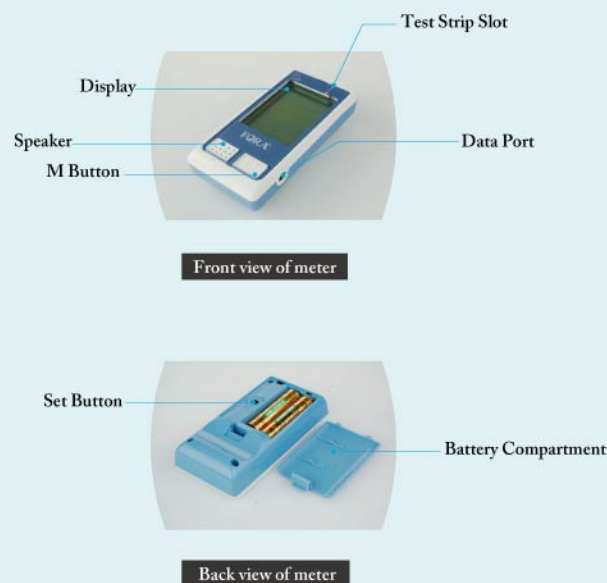

**Items For Testing** (Lancing device, lancets, and clear cap not included.)



**1. Set The Meter**

1-1



1-2

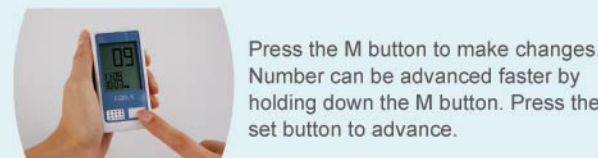

**1. Set The Meter**

1-3



Date flashes. Follow step 2 for changes. The sequence of settings after date is: time → memory deletion → speaking volume → language selection.

The meter will automatically turn off if setting is complete. For memory deletion, please refer to your Owner's Manual for details.

Quick Start User Guide

**2. Set The Lancing Device**

(Lancing device, lancets, and clear cap not included.)

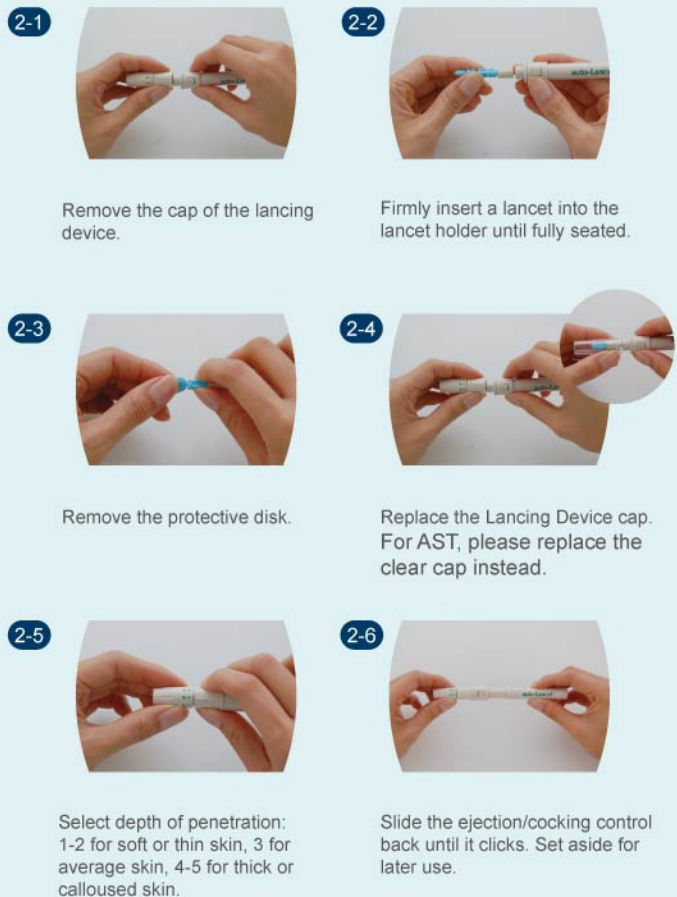

**3. Test Your Blood Glucose**



**3. Test Your Blood Glucose**



**4. Read Your Result**

Your blood glucose result comes with indicators Lo/KETONE ?/Hi

low	KETONE?	high
Appears when glucose < 20 mg/dL	Blink when glucose ≥240 mg/dL	Appears when glucose > 600 mg/dL

If lancing device differs, please refer to manufacture's manual for proper usage.

For more information about control solution test, please refer to the Owner's Manual page 20.

Quick Start User Guide